

Aufbau mit 1 Person
 Montage avec 1 personne
 Uitbreiding met 1 persoon

Aufbauanleitung Schubkasten "Pico"

Instructions de montage tiroir « Pico »

Montagehandleiding lade "Pico"

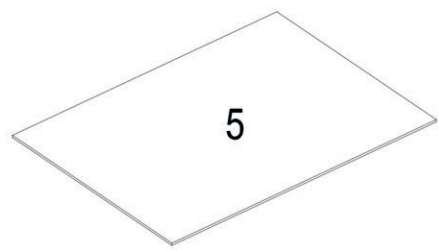

- x 2

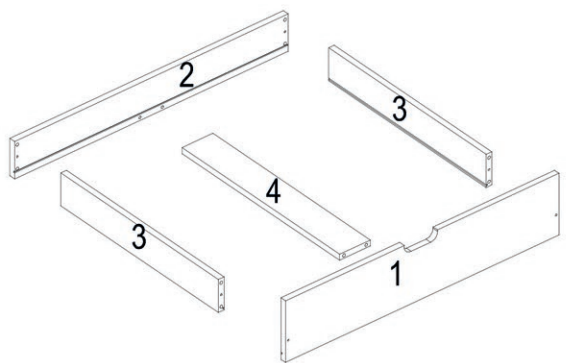

- x 2

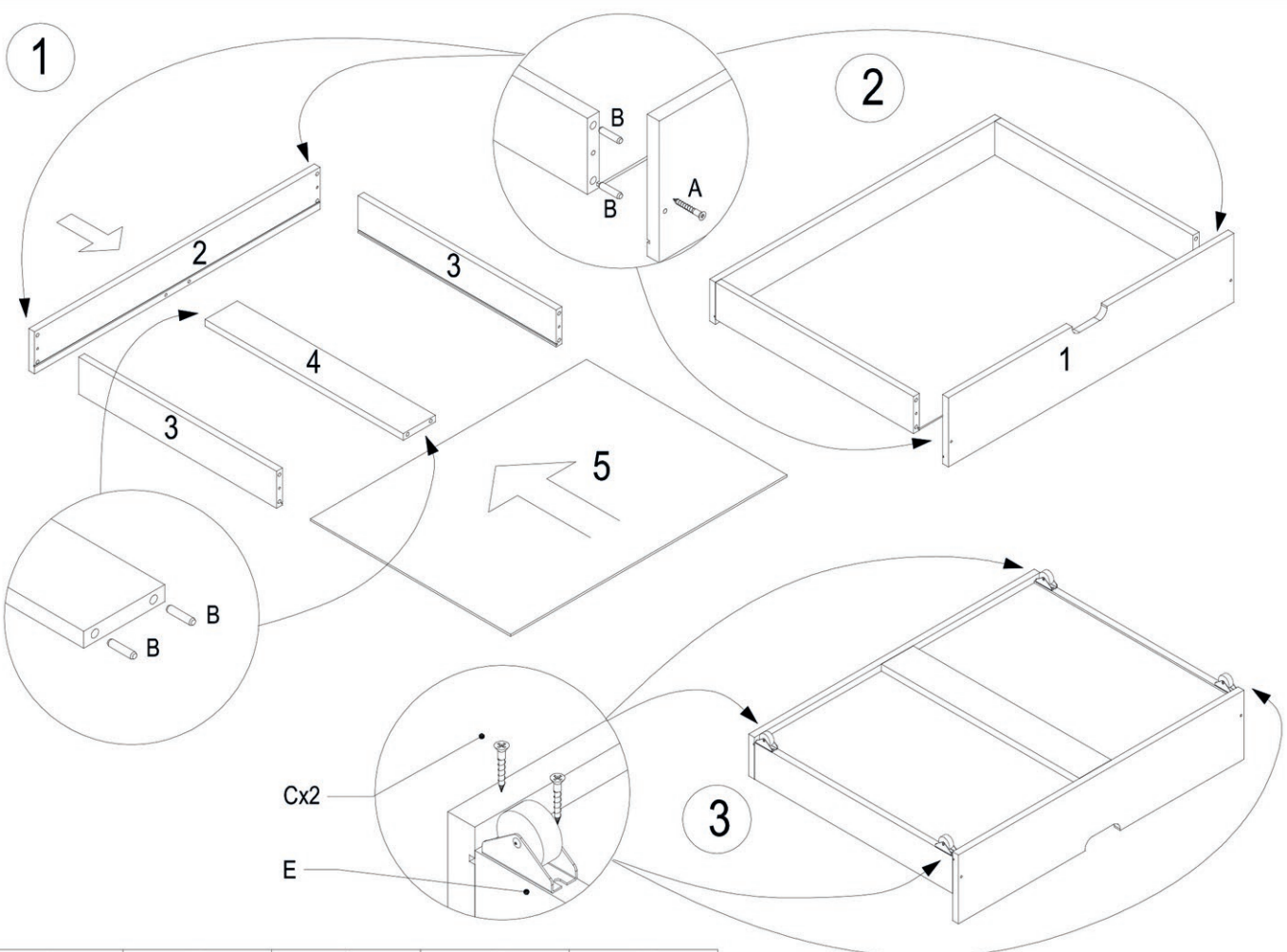

| A | B | C | D | E |
|------|-------|--------|----|----|
| 7x50 | Ø8x30 | 3,5x25 | N4 | |
| | | | | |
| x8 | x24 | x16 | x1 | x8 |